



DIGITAL ENABLERS

Simplantology, In Everything We Do

CadCam

BRINGING 3 DECADES OF EXCELLENCE & PRECISION INTO OUR CAD/CAM PRODUCTS AND DIGITAL LIBRARIES.

Alpha-Bio Tec introduces a comprehensive range of CAD/CAM restoration products for Internal Hex and Conical platforms. All products feature original Alpha-bio Tec connections with the exact tolerances, ensuring best reliable implant to restoration fit, and offer solutions for single tooth and bridge restorations.

Dual Use Scan Bodies (for lab and/or intra-oral use)

Unique geometry for precise transfer of implant position, trajectory and orientation to the CAD system. Peek body and titanium base for accurate, long lasting use. The scan bodies are biocompatible and autoclavable.

Titanium Bases

Used as abutment bases for digital restorations with Alpha-Bio Tec original implant connection. Parts available in a range of gingival heights.

Adhesive Copings

Adhesive copings are used as adapters for screw retained zirconium restorations at abutment level - multi-unit angled and straight abutments (TCT-N connection). Zirconia restorations may not withstand the screw forces, thus for cases where there is no plan for a metal frame, the adhesive coping is indicated. A direct mounting screw is available for restorations without adhesive copings.

Pre-milled Blanks Are used as raw material for CAM fabrication of a single part (monolithic) titanium abutment. Original pre-milled implant connection is fabricated with the exact tolerances, ensuring best reliable implant to restoration fit. Fits Medentika's® Preface abutment holder.

CAD/CAM Libraries Software libraries contain all relevant Cad/Cam parts - Scan Bodies, Ti-Bases, Adhesive Copings, Screws, Analogs and Pre-Milled Blanks. Alpha-Bio Tec. Libraries enable simple and easy designing and manufacturing of your restorations for support all Alpha-Bio Tec. implant platforms. All products are available and supported by leading CAD/CAM systems.

Please refer to Alpha-bio Tec website to download our libraries.

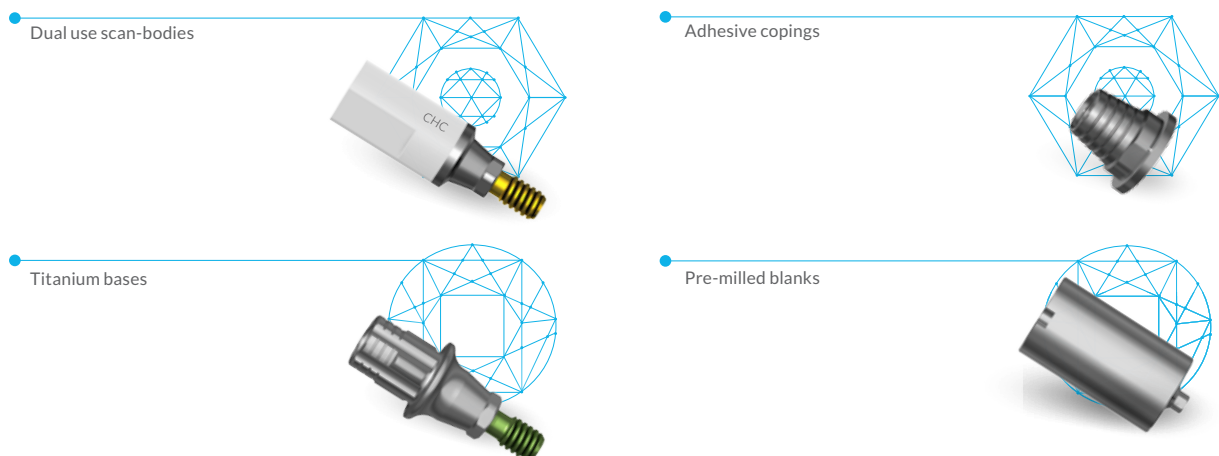

All products are available and supported by leading CAD/CAM system libraries including:

3shape

exocad

dental wings

Dental Wings, AmannGirrbach, 3shape, exocad and egs are trademarks or registered trademarks of their respective owners: Dental Wings LLC., Amann Gribbach AG, 3Shape A/S, exocad GmbH. Alpha-Bio Tec is neither endorsed, nor sponsored, nor affiliated with the owners of these trademarks or registered trademarks.



Internal Hex Connection

SUPPORTED IMPLANTS: MultiNeO, Spiral, ICE, DFI



Dual Use Scan Body
Height 10 mm

SB-IH
5019

Standard abutment screw included.
Use standard driver - 4052

	Ti Bases				Ti Bases - Wide	
	Engaged (single tooth)		Non Engaged (bridges/bars)		Engaged (single tooth)	Non Engaged (bridges/bars)
Gingival Height	0.7 mm	2.5 mm	0.7 mm	2.5 mm	0.7 mm	0.7 mm
Dimensions	A: Ø4.5 mm B: 5 mm C: 5.7 mm D: 0.6 mm	A: Ø4.5 mm B: 4 mm C: 6.5 mm D: 0.6 mm	A: Ø4.5 mm B: 5 mm C: 5.7 mm D: 0.7 mm	A: Ø4.5 mm B: 4 mm C: 6.5 mm D: 0.7 mm	A: Ø6 mm B: 3.5 mm C: 4.2 mm D: 1.2 mm	A: Ø6 mm B: 3.5 mm C: 4.2 mm D: 1.43 mm
Code	CCTB	CCTB-2.5	CCTB-R	CCTB-R-2.5	WCCTB	WCCTB-R
Ref. No.	5024	4951	5025	4952	5007	5008

* Standard abutment screw included.

Pre-milled blanks			
Dimensions	A: Ø11.5 mm B: 20.2 mm	Dimensions	A: Ø15.8 mm B: 20.25 mm C: 15.25 mm D: Ø11.5 mm
Code	BA-PF-IH	Code	WBA-PF-IH
Ref. No.	4988	Ref. No.	4989
Instructions	For PreFace® abutment holder		

* Standard abutment screw included.

	Screws		Analog	
Code	STLAS	STLAT	IA	AN-PM
Ref. No.	5122	5121	5080	4995
Instructions	Standard abutment screw (included in package)		For lab use (optional)	For printed models



Conical Hex Connection

SUPPORTED IMPLANTS: MultiNeO (Ø3.5, Ø3.2), NICE



Dual Use Scan Body
Height 10 mm

SB-CHC
5021

For lab use and intra-oral.
CHC abutment screw included

Ti Bases

	Engaged (single tooth)		Non Engaged (bridges/bars)	
Gingival Height	0.7 mm	2.5 mm	0.7 mm	2.5 mm
Dimensions	A: Ø3.8 mm B: 5 mm C: 5.7 mm D: 0.4 mm	A: Ø3.8 mm B: 4 mm C: 6.5 mm D: 0.42 mm	A: Ø3.6 mm B: 5 mm C: 5.7 mm D: 0.5 mm	A: Ø3.8 mm B: 4 mm C: 6.5 mm D: 0.5 mm
Code	CCTB-CHC	CCTB-CHC-2.5	CCTB-CHC-R	CCTB-CHC-R-2.5
Ref. No.	5026	4953	5027	4954

* CHC abutment screw included.

Pre-milled blanks

Dimensions		A: Ø11.5 mm B: 20.2 mm
Code		BA-PF-CHC
Ref. No.		4990
For PreFace® abutment holder		

* CHC abutment screw included.

Screw

Analogs

Code	STLA-CHC	IA-CHC	AN-PM-CHC
Ref. No.	7345	7338	4996
Instructions	CHC abutment screw (included in package)		For printed models



Conical Standard Connection

SUPPORTED IMPLANTS: MultiNeO (Ø3.75, Ø4.2, Ø5.0)



Dual Use Scan Body
Height 10 mm

IOSB-CS
3837

CS abutment screw included.
Use standard driver - 4052

Ti Bases - Engaged (Single tooth)

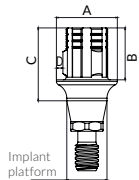

Gingival Height	0.75 mm	1.5 mm	2.5 mm
Dimensions	A: Ø4.7 mm B: 4 mm C: 4.87 mm D: 0.5 mm	A: Ø4.7 mm B: 4 mm C: 5.62 mm D: 0.53 mm	A: Ø4.7 mm B: 4 mm C: 6.62 mm D: 0.5 mm
Code	TB_0.75_AR_CS	TB_1.5_AR_CS	TB_2.5_AR_CS
Ref. No.	3832	3840	3842

* CS abutment screw included.

Ti Bases - Non Engaged (For bridge/bar)

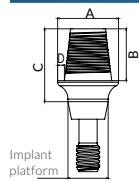

Gingival Height	0.75 mm	1.5 mm	2.5 mm
Dimensions	A: Ø4.7 mm B: 4 mm C: 4.87 mm D: 0.53 mm	A: Ø4.7 mm B: 4 mm C: 5.62 mm D: 0.53 mm	A: Ø4.7 mm B: 4 mm C: 6.62 mm D: 0.53 mm
Code	TB_0.75_R_CS	TB_1.5_R_CS	TB_2.5_R_CS
Ref. No.	3833	3841	3843

* CS abutment screw included.

Pre-milled Blanks

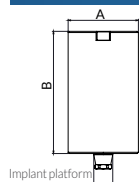



Dimensions	A: Ø11.5 mm B: 20 mm	A: Ø15.8 mm B: 20 mm C: 15 mm
Code	BA_PF_CS	WBA_PF_CS
Ref. No.	3854	3855

Instructions CS abutment screw included | For PreFace® abutment holder



Conical Standard Connection

SUPPORTED IMPLANTS: MultiNeO (Ø3.75, Ø4.2, Ø5.0)

	Screw	Analog	
			
Code	STLA-CS	IA-CS	AN-PM-CS
Ref. No.	3510	3459	3838
Instructions	CS abutment screw (included in package)		For printed models



TCT-N For Multi-Unit Abutments

SUPPORTED IMPLANTS: MultiNeO, Spiral, ICE, DFI, NICE

	Dual Use Scan Bodies		Adhesive Copings	
			Engaged (single tooth) 	Non Engaged (bridges/bars) 
Height	Height: 7 mm	Height: 7 mm		Height: 3.5 mm
Code	IOSB-TCT-N-R	IOSB-TCT-N	TAC-TCT-N	TAC-TCT-N-R
Ref. No.	3883	5003	5028	5029
Instructions	For bridge restoration with multi-unit straight and angled abutments	For single crown restoration with multi-unit angled abutments	For single crown restoration with multi-unit angled abutments	For bridge restoration with multi-unit straight and angled abutments

* Screw included.

	Screws			Analog	Insertion Tool
					
Code	SF-N	SFT-N	S-DM-SR	AN-PM-TCT-N	APMT-IH-CS-TCT-N
Ref. No.	6092	6093	4994	5456	5459
Instructions	Standard multiunit TCT-N screw (included in package)	Lab use multiunit TCT-N screw	For direct mounting	Multi-Unit/TCT analog for 3D printed model*	Analog Printed Model insertion tool

* Compatible for exocad system. For 3Shape and Dental Wings, use 5211.

Sirona Compatible

Original Alpha-Bio Tec. Ti-Bases for Sirona's L Blocks.



Internal Hex (IH) Connection

SUPPORTED IMPLANTS: MultiNeO, Spiral, ICE, DFI

	Ti Base	Scan Post	Screws	
Code	CCTB-IH-SI	CCSP-IH-SI	STLAS	STLAT
Ref. No.	4980	4984	5122	5121
Instructions	For scan and/or restoration use	For scanning purpose only	Standard abutment screw (included in package)	For lab use (optional)



Conical Hex (CHC) Connection

SUPPORTED IMPLANTS: MultiNeO (Ø3.5, Ø3.2), NICE

	Ti Base	Scan Post	Screw
Code	CCTB-CHC-SI	CCSP-CHC-SI	STLA-CHC
Ref. No.	4982	4985	7345
Instructions	For scan and/or restoration use	For scanning purpose only	CHC abutment screw (Included in package)

Omnicaam, Blucam, Inlab, Cerec, Incoris and Zimmer are trademarks or registered trademarks of Sirona Dental and Zimmer GMBH. Alpha-Bio Tec. is neither endorsed, nor sponsored, nor affiliated with the owner of these trademarks or registered trademarks.

For more information please refer to our website.



Conical Standard (CS) Connection

SUPPORTED IMPLANTS: MultiNeO (Ø3.75, Ø4.2, Ø5.0)

	Ti Base				Scan Post	Screw
Code	CSTB-CS-SI	SiTB-CS-1.5	SiTB-CS-2.5	SiTB-CS-3.5	CSSP-CS-SI	STLA-CS
Ref. No.	3856	5470	5471	5472	3857	3510
Instructions	For scan and/or restoration use				For scanning purpose only	CS Abutment screw (included in package)

* Use 1.25 mm driver @30Ncm.



 **ALPHA Bio**_{TEC}
Simplantology

Simplantology, In Everything We Do

Alpha-Bio Tec's products are cleared for marketing in the USA* and are CE-marked in accordance with the Council Directive 93/42/EEC. Alpha-Bio Tec's complies with EN ISO 13485:2016. Product availability may vary between countries.

www.alpha-bio.net

